

FITTING INSTRUCTIONS

Subaru Forester 07/18-on – T4S763

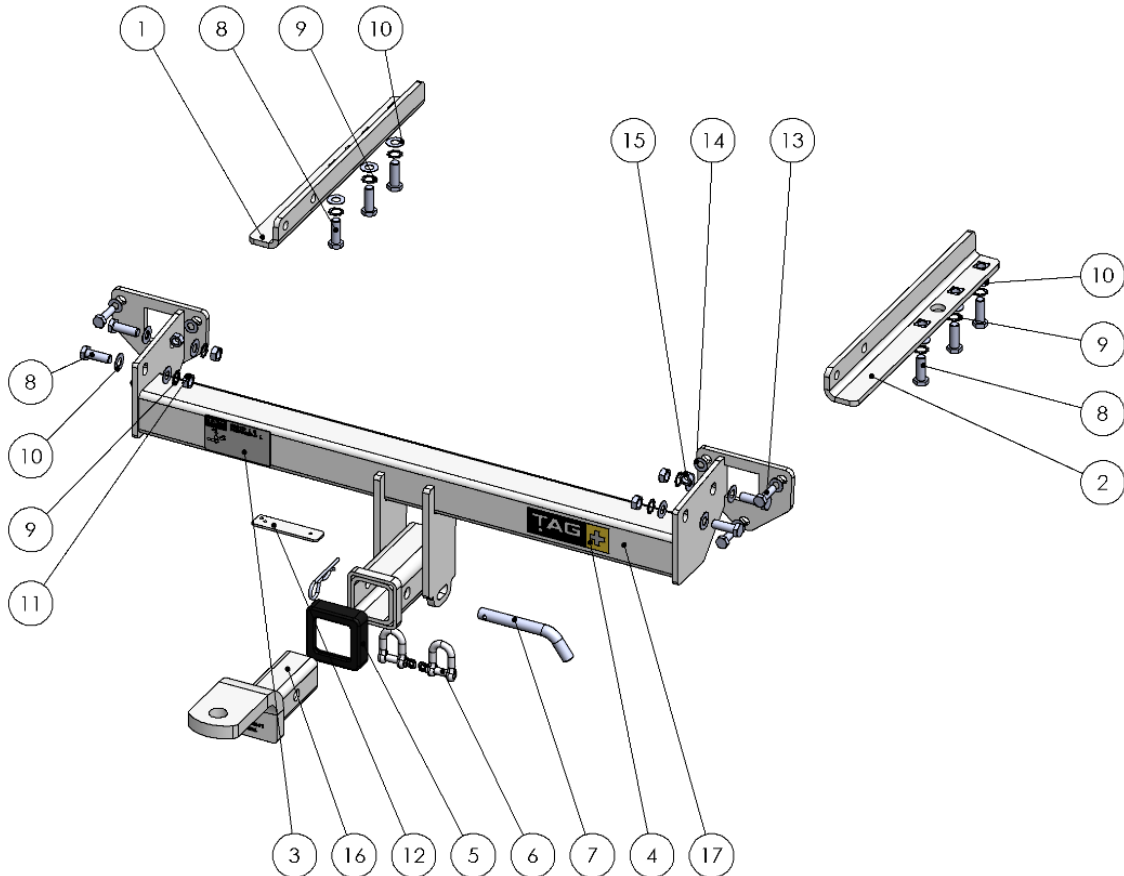

Max Towing Capacity: 1800kg	Towbar Weight: 21 kg
Max Ball Load: 180kg	Wiring Harness Part #:
 Tools Required: Spanners, Sockets, Screwdriver, Torque wrench	



ITEM NO.	DESCRIPTION	QTY.
1	End Plate Assy PS	1
2	End Plate Assy DS	1
3	TAG Compliance plate	1
4	TAG + Foil Sticker 123x38	1
5	Cover Hitch Receiver Collar TAG	1
6	TAG D-Shackle - 10mm, 1000kg, Galvanised	2
7	Class 4 Pin & Clip	1
8	M12x1.75x35 Bolt	10
9	M12 Shakeproof Washer	10

ITEM NO.	DESCRIPTION	QTY.
10	M12 Flat Washer Zinc Clear	14
11	M12 1.75 PITCH NUT METRIC HEX	4
12	Backing Plate - 7 Pin Flat Connector	1
13	M10x1.25x35 Bolt	4
14	M10 FLAT WASHER FLAT ROUND ZINC CLEAR	6
15	M10 X 1.25 PITCH NUT HEX DIN 9	2
16	TAG Tow Ball Mount - L4120, 90° Face, 50mm Square Hitch	1
17	Weld Assembly T4S763	1

FITTING INSTRUCTIONS

Subaru Forester 07/18-on – T4S763



**ENSURE THAT THE FITTING INSTRUCTIONS ARE READ AND UNDERSTOOD PRIOR TO FITMENT
PLACE THESE INSTRUCTIONS IN THE VEHICLE'S GLOVEBOX AFTER INSTALLATION IS COMPLETED**

Warning:

- This product is for towing purposes only and must only be loaded as shown in your vehicle Owner's Manual.
- This towbar is NOT to be drilled, cut, welded, or modified in any way.
- All load ratings shown are under the assumption your trailer has a functional braking system installed
- When installed in positions other than the one depicted in these instructions the Tow Ball Mount may interfere or obstruct certain features of your vehicle (tailgate opening, Chassis clearance, etc.)

General:

- Before fitting this towbar check installation hardware is included and correct.
- Check that the towbar is suitable for the vehicle make, model and year then make sure any changes to the vehicle design do not conflict with the fitting of this towbar. (Tray, Canopy, Suspension etc.)
- After drilling, blow any filings clear, remove any swarf and treat exposed metal with a rust inhibitor.
- Check behind chassis rail and body panels before drilling to ensure no hazards are present (fuel lines, electrical wires etc.)
- If this vehicle requires a bumper cut out, please check to make sure that your measurements are correct and clear before cutting any panels as some bumper profiles can change. If you are not sure, then please ask your towbar supplier
- The high tensile fasteners supplied with this product are an integral feature to achieving the specified rating, if replacement is required ensure that fasteners of the same grade (8.8) & quality are used. Contact an authorised TAG distributor or the TAG fitment centre - (07) 3208 3022 - if further information is required.

Towbar Maintenance and Care:

It is recommended, when not in use, the Tow Ball Mount assembly and class 4 Pin and Clip is stored inside the car away from moisture to prevent standing water from forming rust. Inspect to ensure, on regular basis, fasteners are torqued to the specifications below and in good condition.

Metric Bolt Torque Settings										
Diameter	Pitch	Grade	Torque	Unit	Diameter	Pitch	Grade	Torque	Unit	
M8	1.25	8.8	29	Nm	M12	1.50	8.8	97	Nm	
M10	1.25	8.8	57	Nm	M12	1.75	8.8	77	Nm	
M10	1.50	8.8	44	Nm	M14	2.00	8.8	122	Nm	
M12	1.25	8.8	101	Nm	M16	2.00	8.8	190	Nm	

FITTING INSTRUCTIONS

Subaru Forester 07/18-on – T4S763



Step 1	Remove Bumper
Instructions	
<ol style="list-style-type: none">a. Inside the RHS wheel arch, remove 2x hex head screws and 1x plastic scrivet. Remove 1x plastic scrivet from behind the wheel arch fastening the mudguard to the bumper. Set mudguard aside for refitting. Repeat on LHS.b. Remove 10x plastic scrivets from the bottom of the bumper starting at RHS wheel arch and working around to LHS.c. Remove plastic guard from behind LHS wheel arch via 2x M6 bolts and a clip holding it onto rear of the wheel arch.d. Open the tail gate. On RHS remove 2x plastic scrivets fastening the plastic cover to the inside of the taillight. Remove the plastic cover. Repeat on LHS.e. Beginning at the RHS wheel arch, gently pull the bumper away from the body following all the way till under the taillights. Repeat on LHS.f. With the help of another, carefully release the bumper from beneath the tailgate opening.g. Disconnect the reverse sensor wiring harness from the bumper at the LHS.h. Remove the crash bar via 2x M10 nuts & 1x M10 bolt from the RHS. Repeat on LHS. Discard crash bar and fasteners.	

FITTING INSTRUCTIONS

Subaru Forester 07/18-on – T4S763



Step 2	Remove Muffler & Heat shield
Instructions	
<ul style="list-style-type: none">a. Remove the 2x rubbers from the exhaust hangers.b. Remove the muffler from the exhaust at the flange via 2x bolts & nuts. Set aside.c. Remove heat shield via 4x M6 bolts.d. Drill 2x 12mm holes in the heat shield using the centre marks located in the pressed lettering of the shield.e. Remove 3x plastic covers/ bungs from the bottom face of each chassis rail and discard.	

Step 3	Fit Towbar
Instructions	
<ul style="list-style-type: none">a. Insert side arms into chassis rails and align with holes in the bottom of the chassis. Loosely secure each side arm with 3x M12x 35 bolts & flat washers.b. Lift main bar up to rear panel and over exposed sidearms to align with holes.c. Secure loosely with 2x M12x 35 bolts with washers & nuts.d. Repeat on opposite side.e. Tighten all bolts to the torque specification on page 2.	

FITTING INSTRUCTIONS

Subaru Forester 07/18-on – T4S763



Step 3 | Cut Bumper

Instructions

The towbar installer is ultimately responsible for the location & quality of the bumper cut. To avoid mistakes, please use the following measurements as a guide only. We suggest making small incremental cuts and regularly test fit the bumper to ensure an accurate and tidy appearance. The additional application of rubber pinch-weld around the cut edge ensures a neat & tidy look.

- a. Establish the centre of the bumper.
- b. Measure, mark and cut a 140mm high x 100mm wide rectangle as measured from the inside bottom edge of the bumper.

Step 4 | Apply Door Sticker

Instructions

- a. Apply one of the compliance labels to the pillar of the driver's door. Leave the remaining label & the fitting instructions in the vehicle handbook.



FITTING INSTRUCTIONS

Subaru Forester 07/18-on – T4S763



WARRANTY STATEMENT

The manufacturer of TAG branded products, warrants your TAG Towbar for its full product life under the following conditions:

- You can show proof of purchase.
- The towbar has been correctly installed by a suitably qualified installer.
- The towbar has not been modified or abused in any way and has only been used for the purpose intended.
- The towbar was not fitted second hand to your vehicle.

The extent of this warranty includes materials and workmanship used in the manufacture of the towbar and is to the equivalent value of current, full replacement cost. Nothing stated or implied in this warranty limits in any way, the statutory rights that you may have.

To make a claim visit the original installer in the first instance or, if you are unable to or are not satisfied with their help, then contact us directly by email at warranty@tagtowing.com