

750113EJ

BMW X5 / G05

11/18 - 06/23



SCAN FOR
LATEST
INSTRUCTIONS

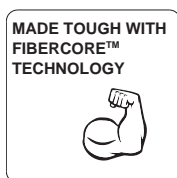
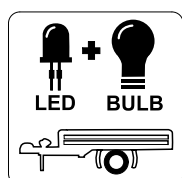
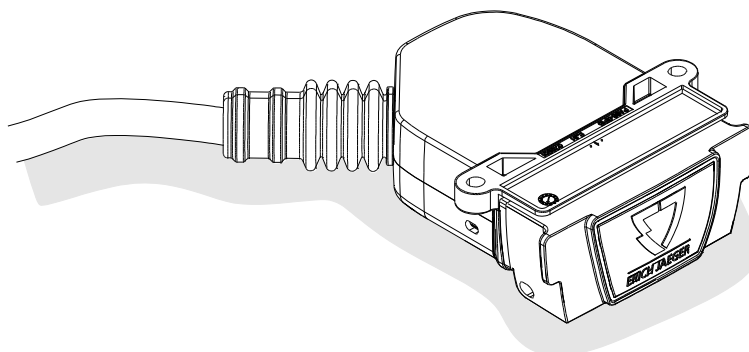

Reference:

The following information must be reviewed before beginning the assembly:

The installation instructions are to be thoroughly read.

The installation should be carried out by qualified personnel with the relevant technical knowledge.

The vehicle manufacturers' current technical notices and information on retrofitting must be followed.

The removal and replacement instructions found in the current repair manuals must be followed.

It must be ensured that the vehicle is technically suitable for the installation of a trailer hitch.

OVERVIEW

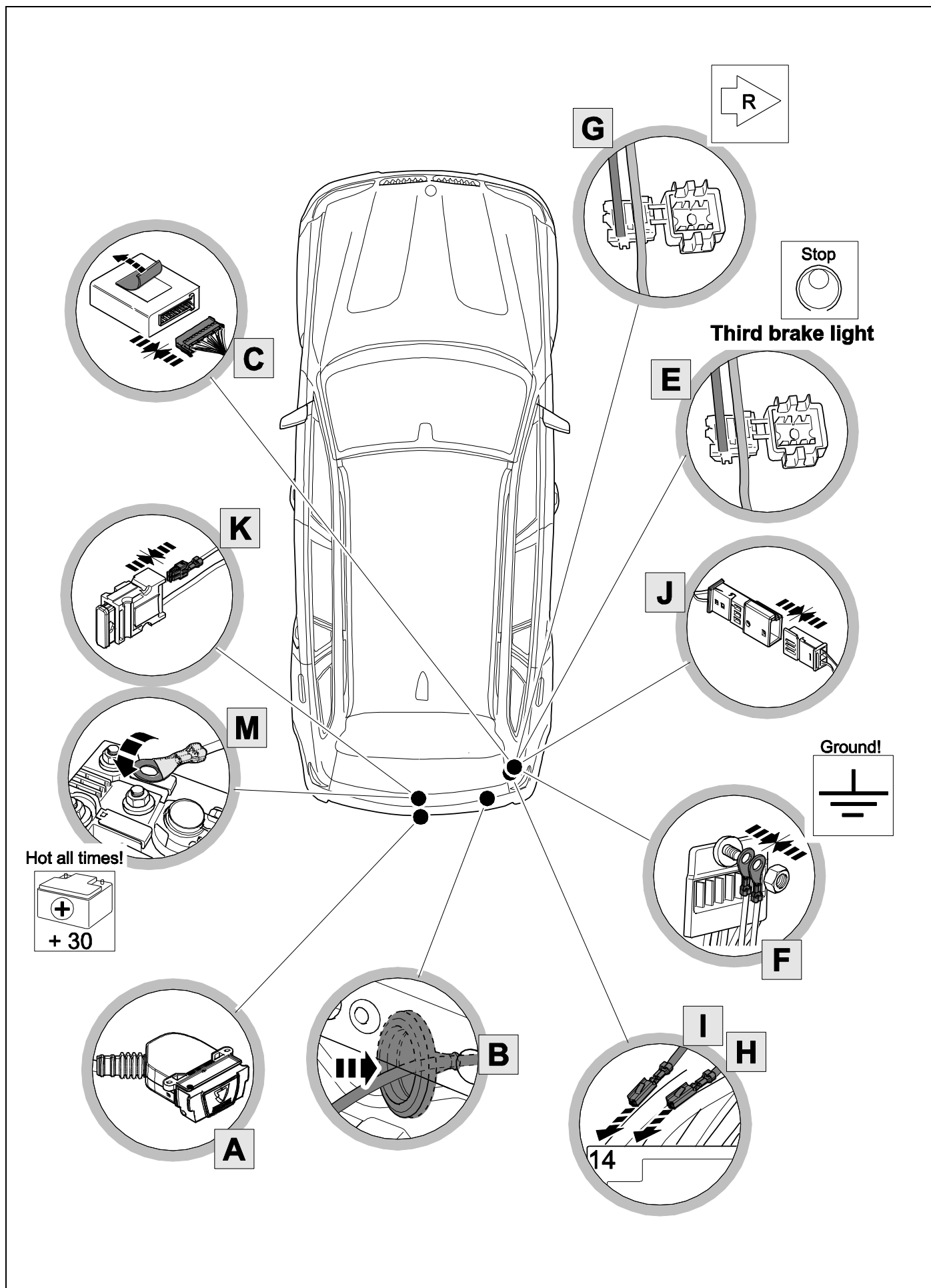

KIT

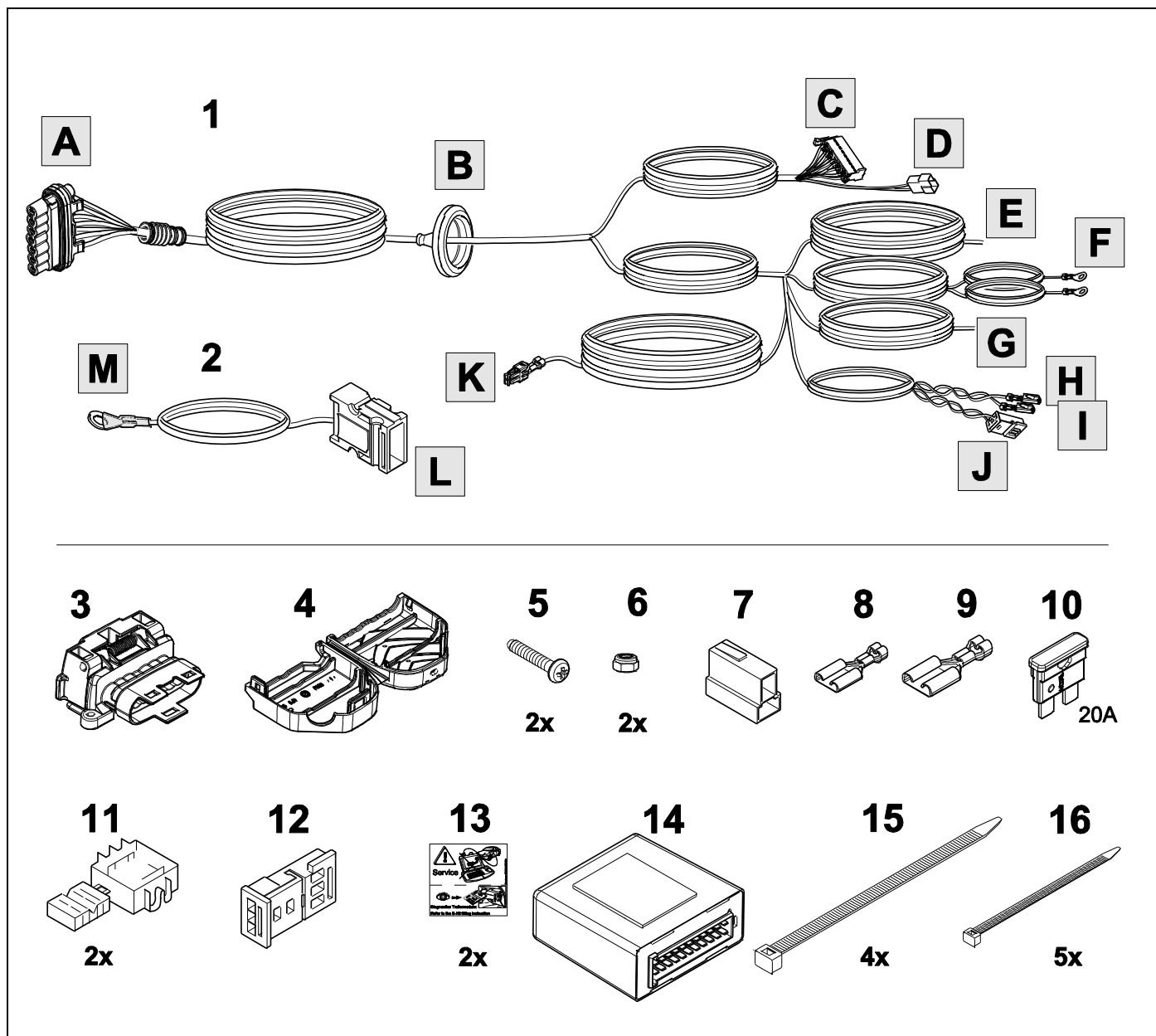

TOOLS

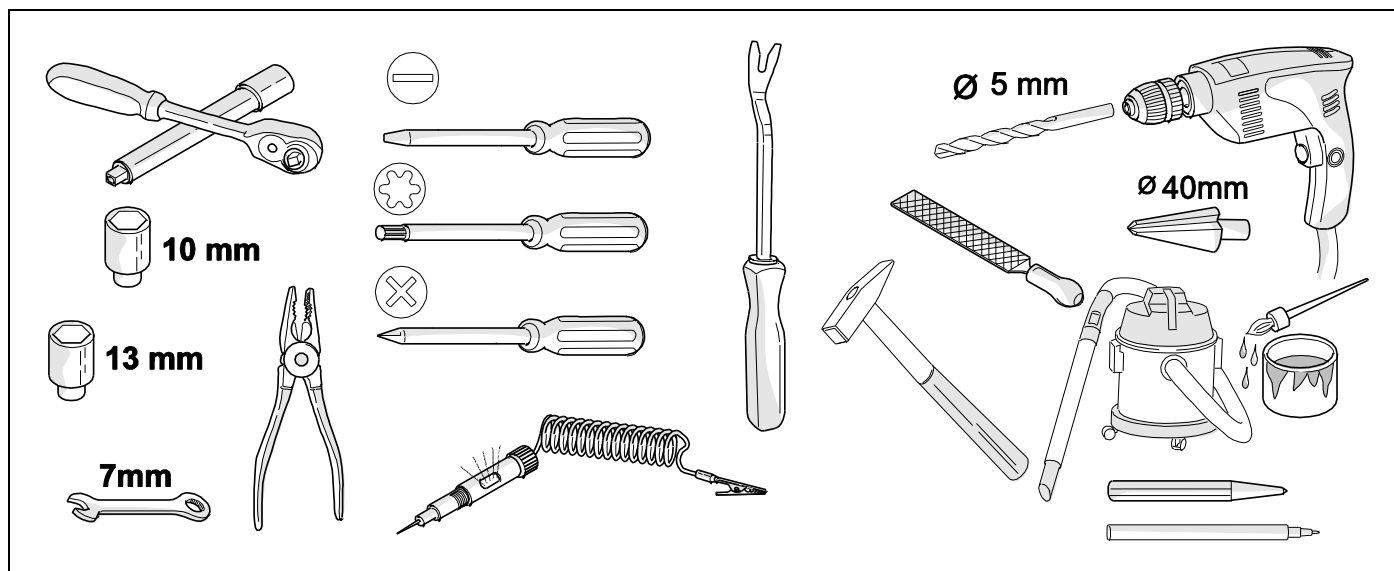

1

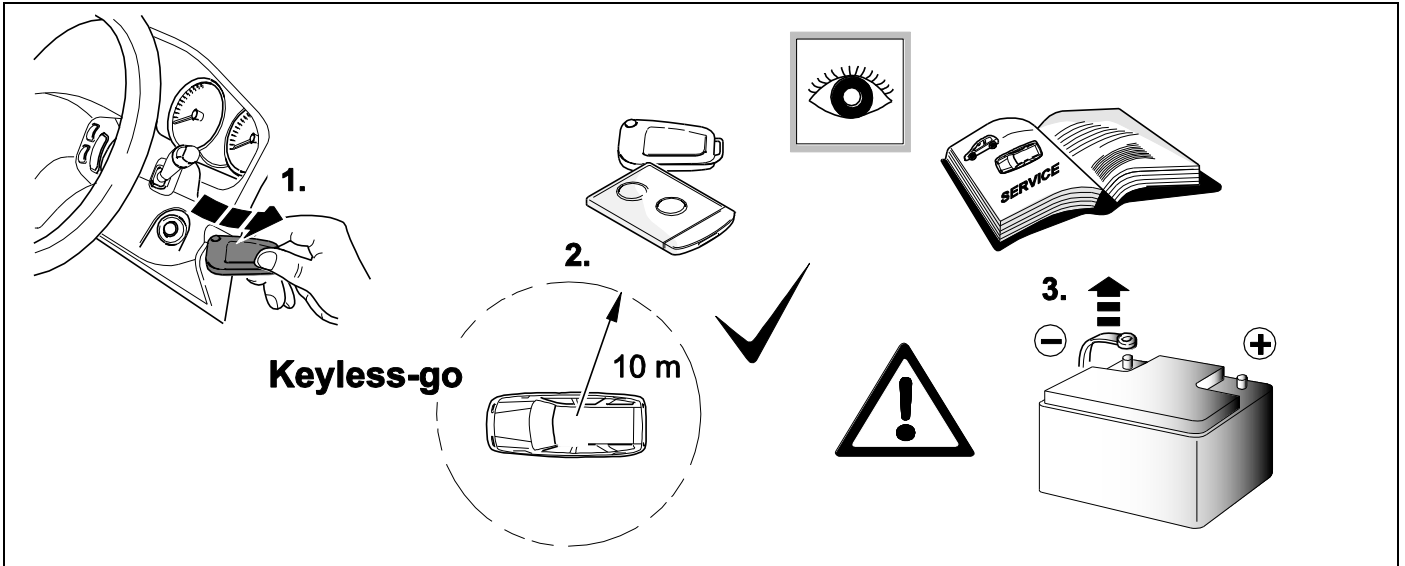

2 REMOVE

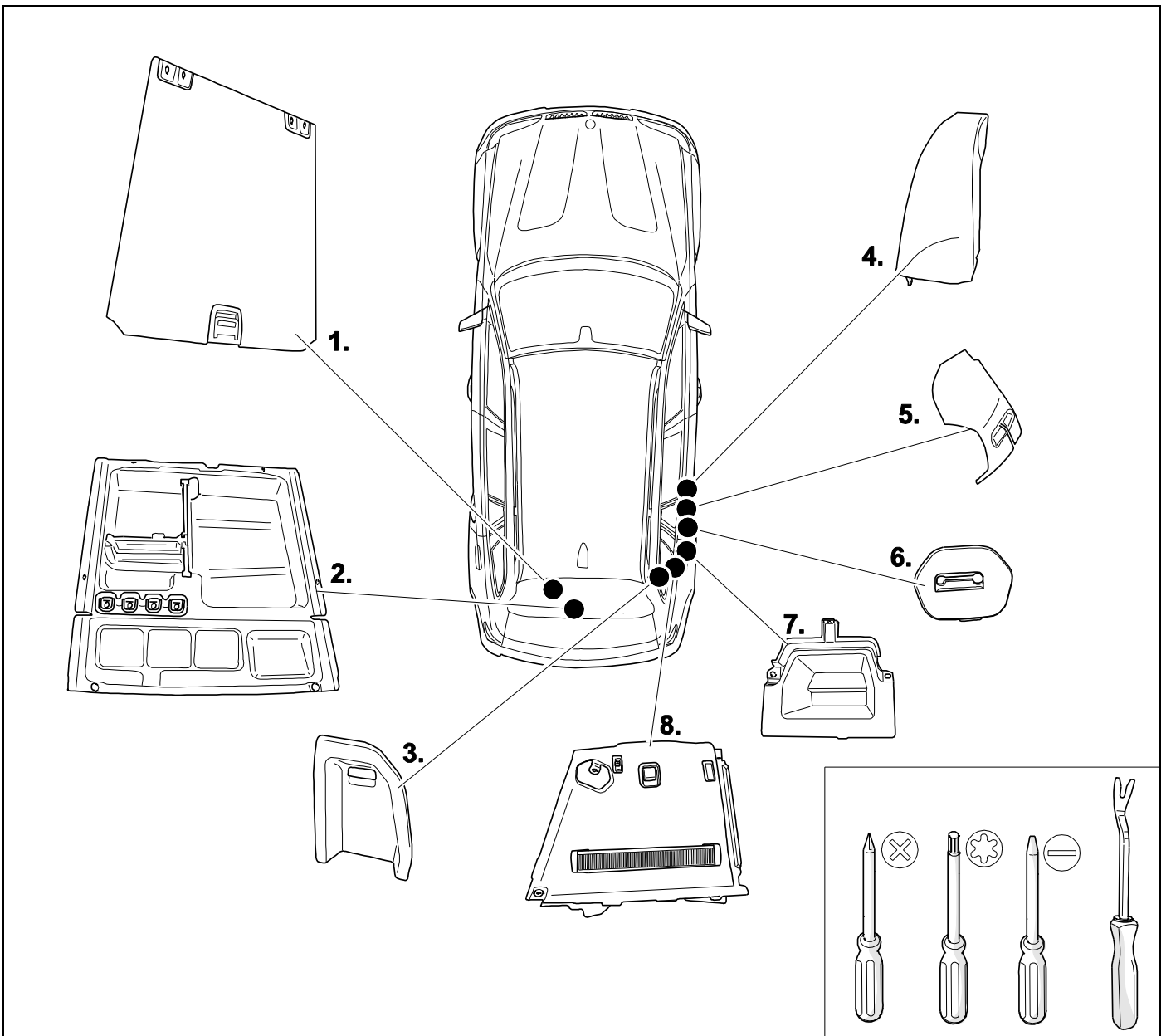

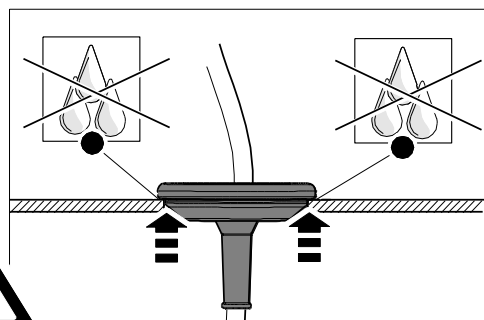
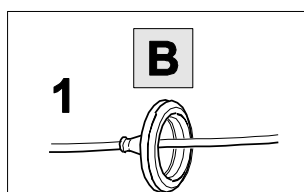
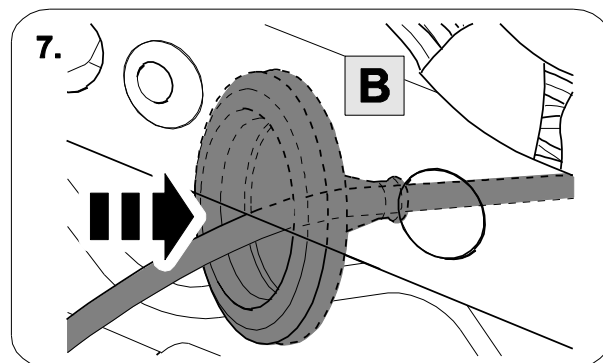
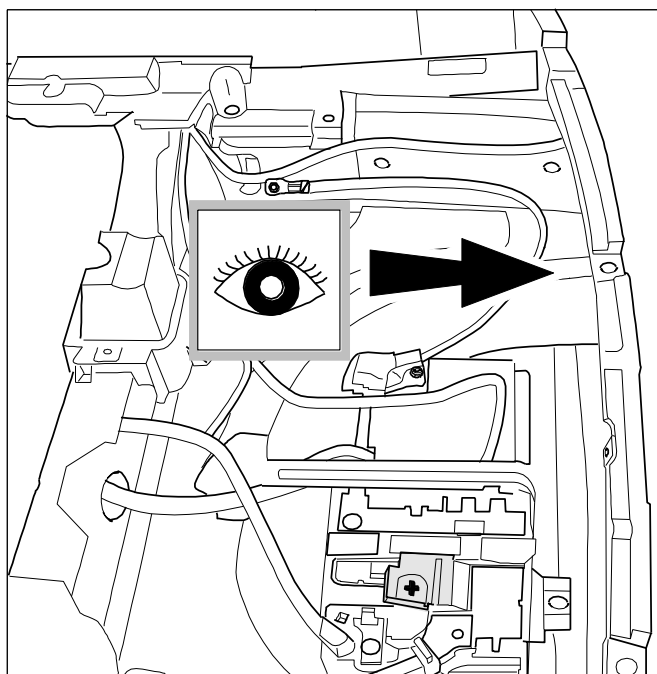
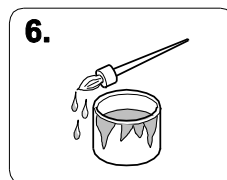
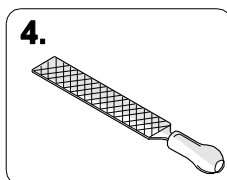
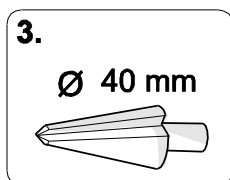
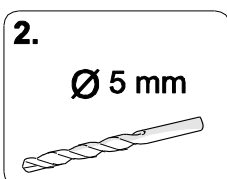
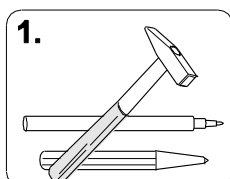
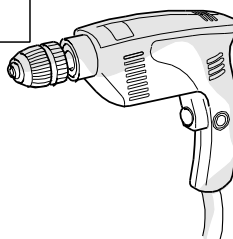
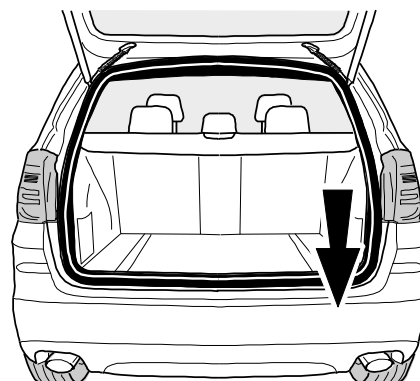
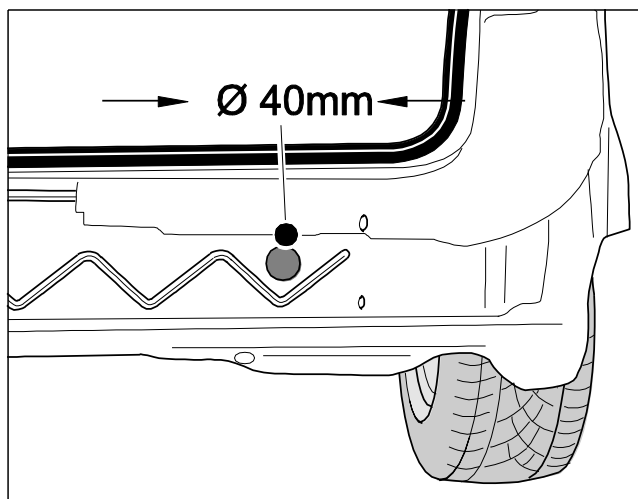

4

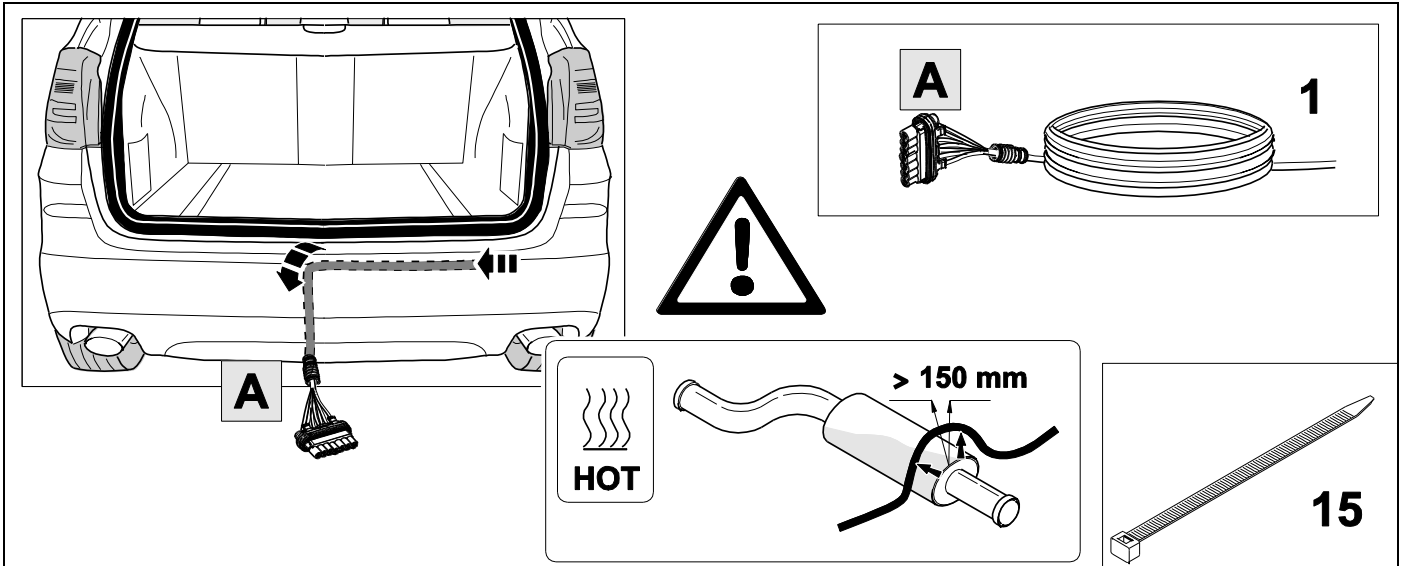

5



7

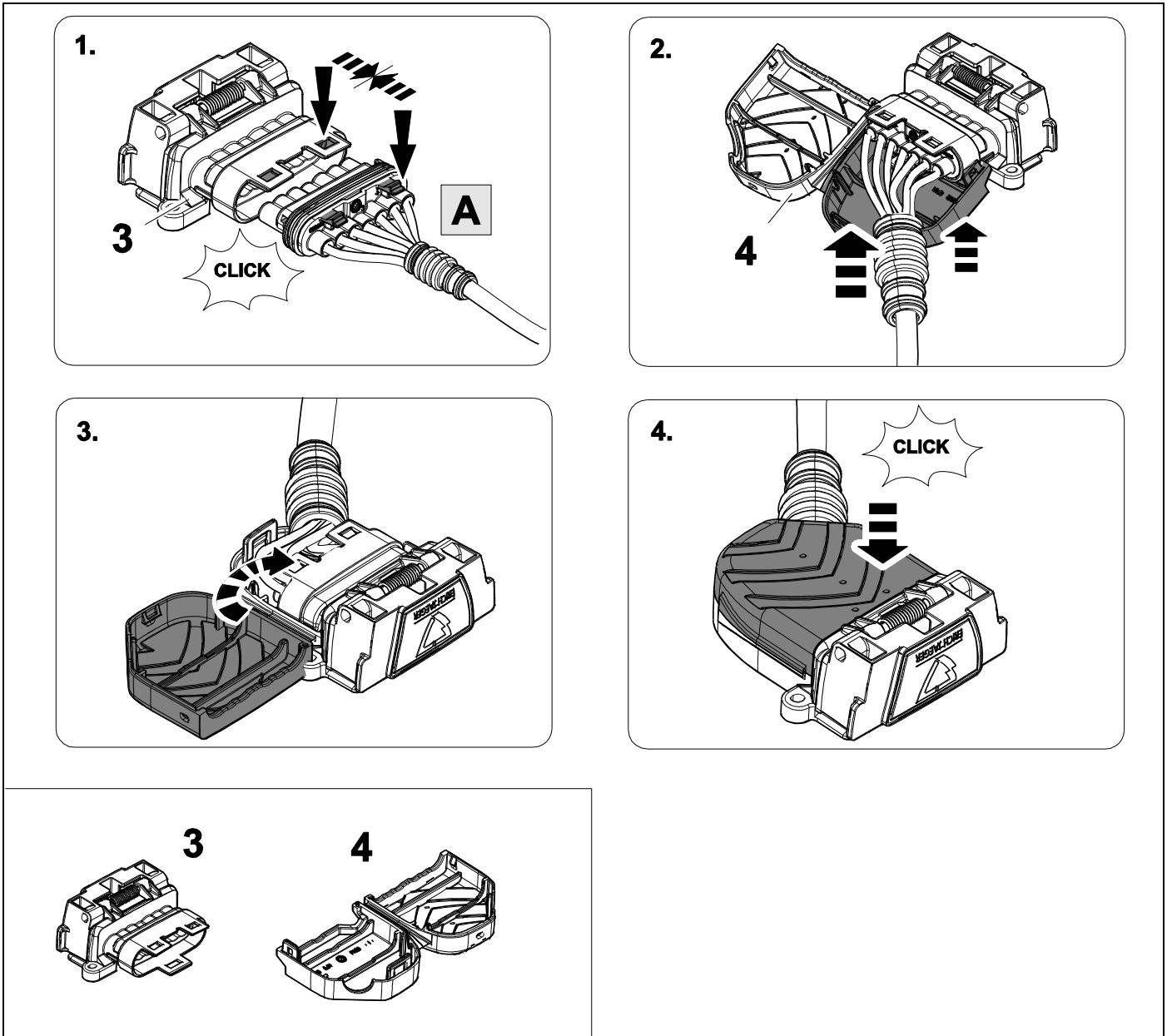

6

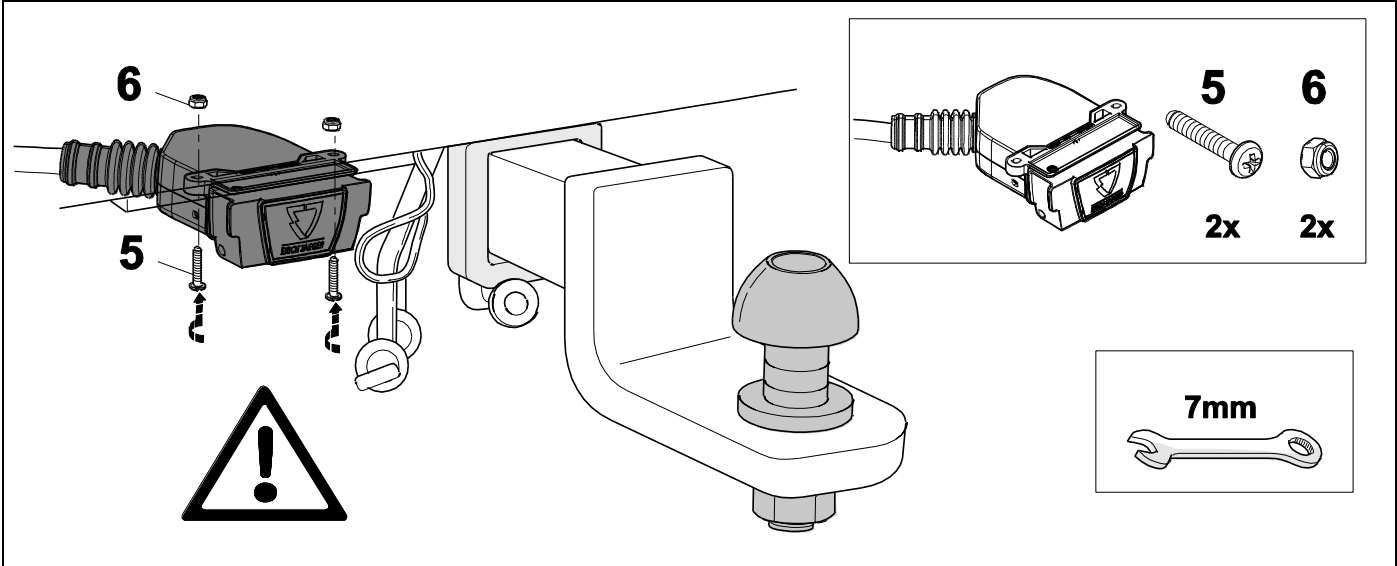

7



8

1	ye	
2	bk	
3	wh	
4	gn	
5	bu	
6	rd	
7	bn	

8	bk	wh	gy	gn	rd	bu	ye	bn	pu	or	no
	black	white	grey	green	red	blue	yellow	brown	purple	orange	not occupied

9



8

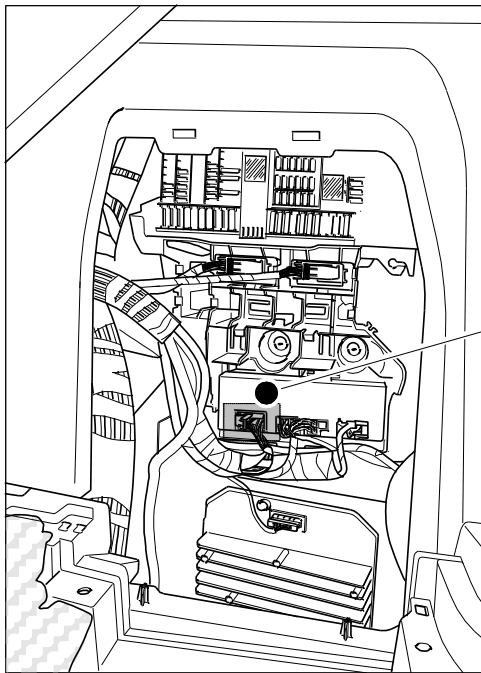

1.

wh

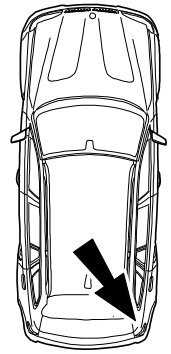
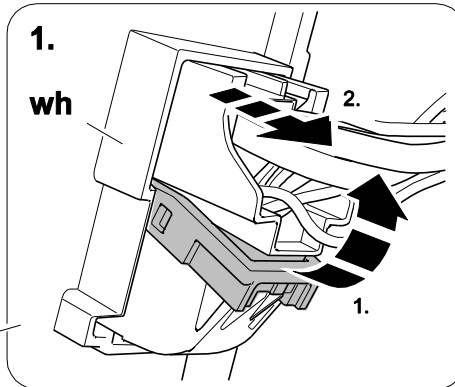

2.

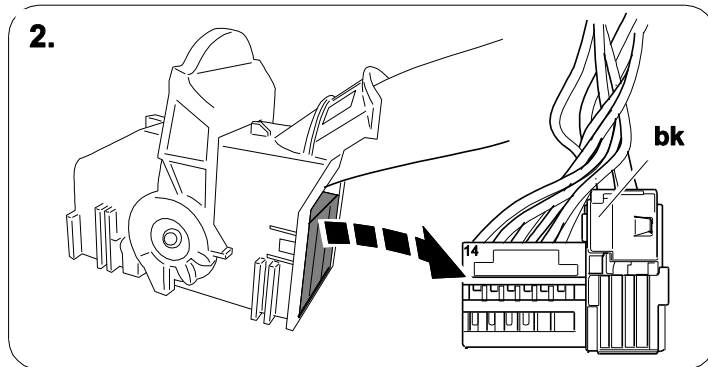

10



8

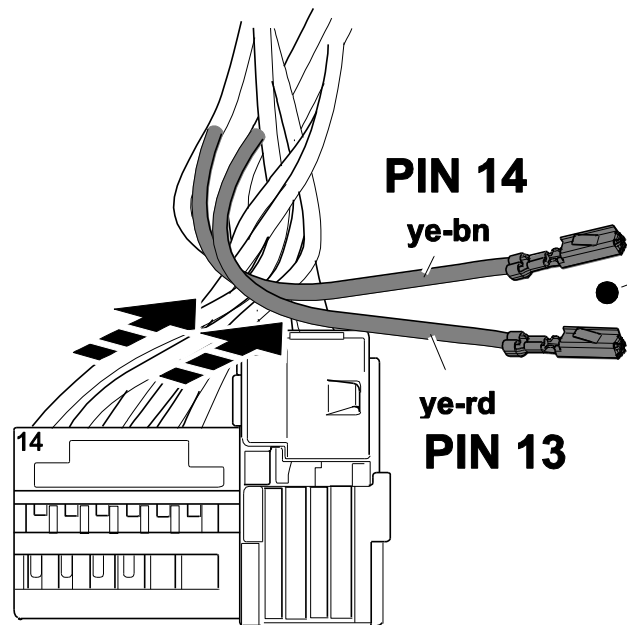

1.

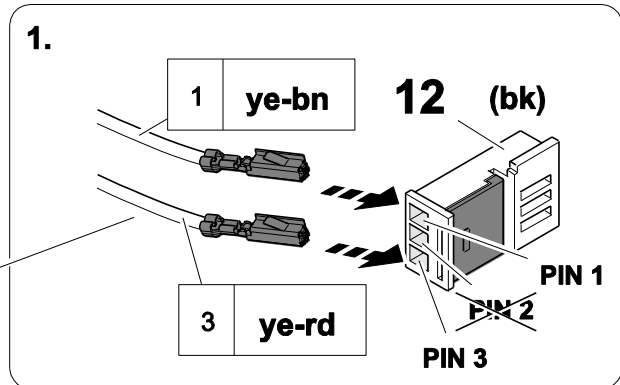

2.

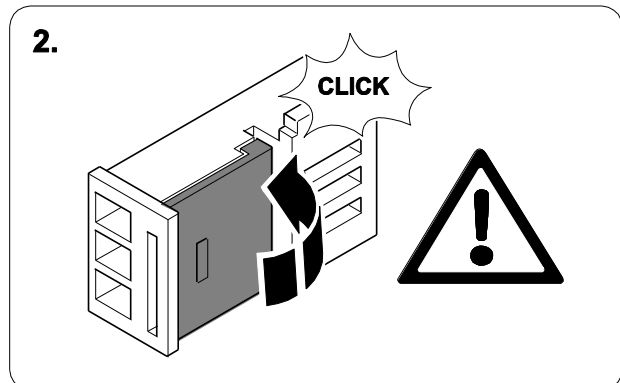

11



8

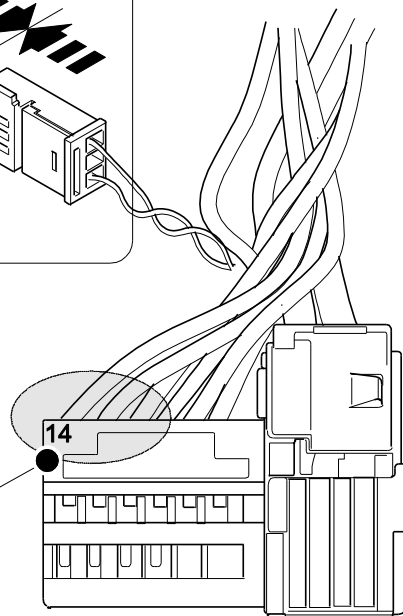
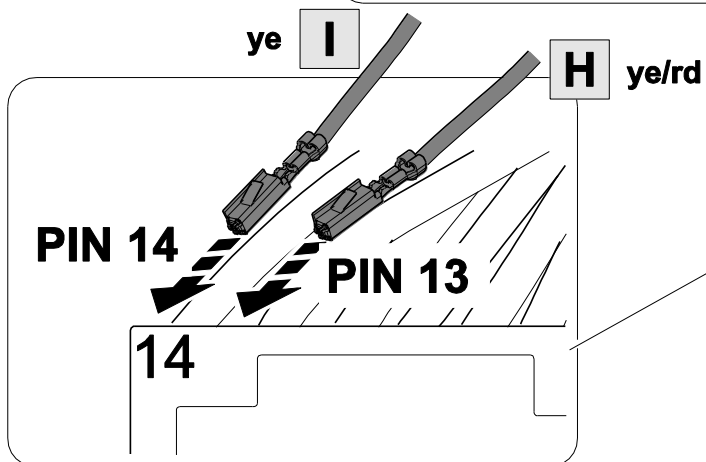
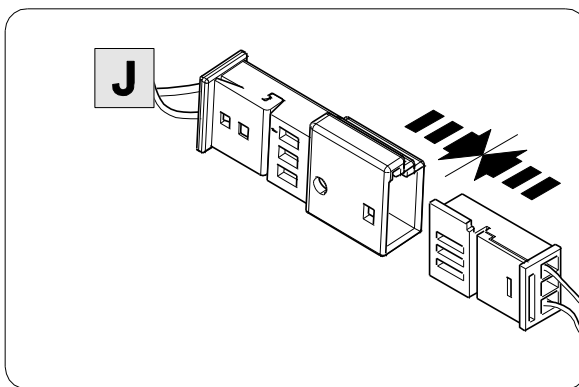
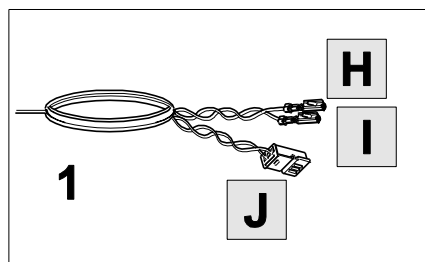

12



8

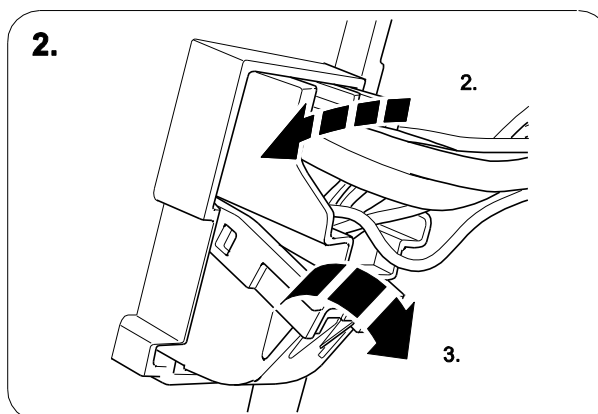
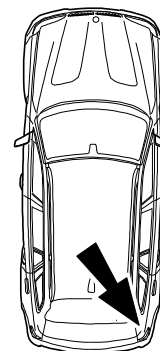
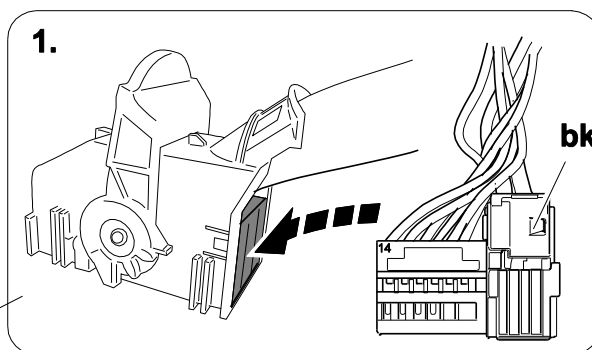
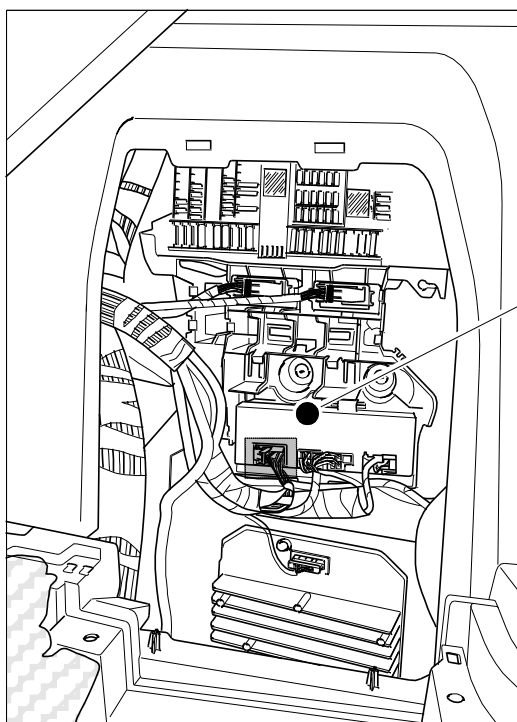

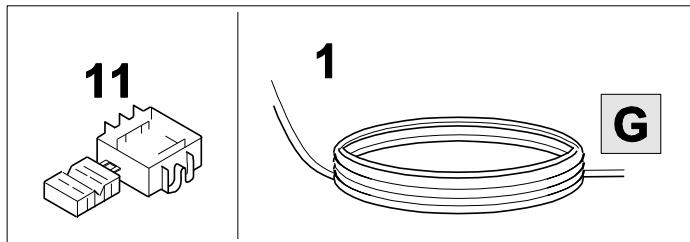
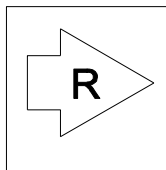
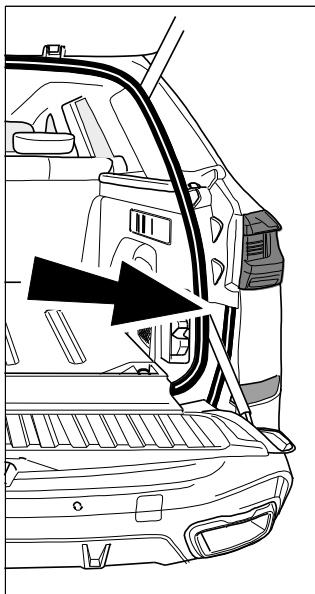

bk-bu **G** wh-rd

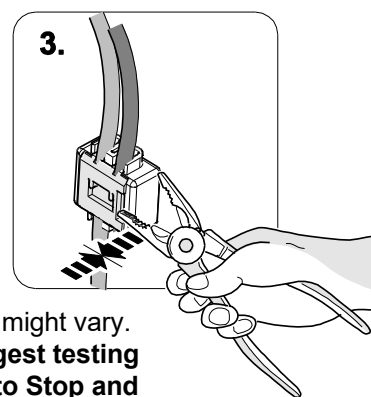
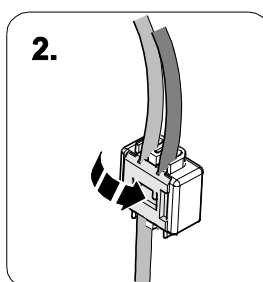
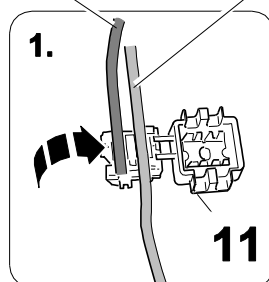

Use a tester to make sure you have connected the correct signals. Wire colours might vary. Incorrect connection might result in battery drain or improper light function. **Suggest testing light functions (Green Diagnostic LED on module) first before connecting to Stop and Indicator signals.** These two connections in step 13 and 14 are optional.

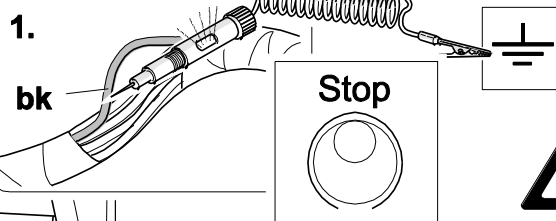
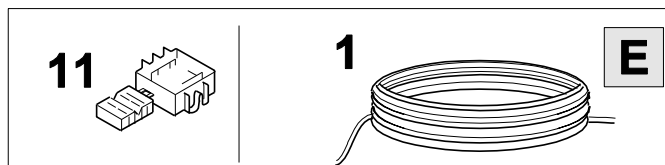
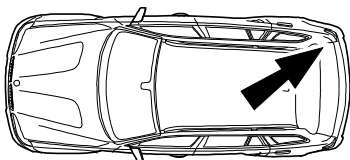

Stop



Third brake light

bk-ye **E**

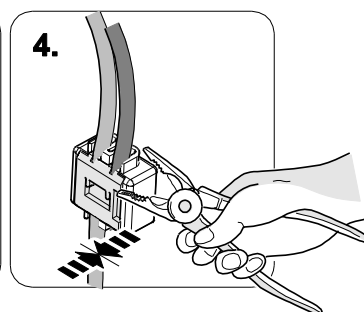
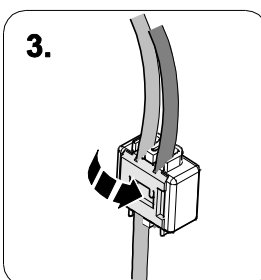
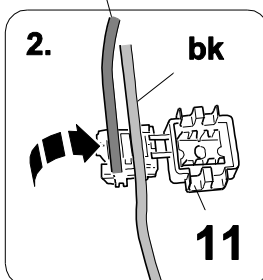

15

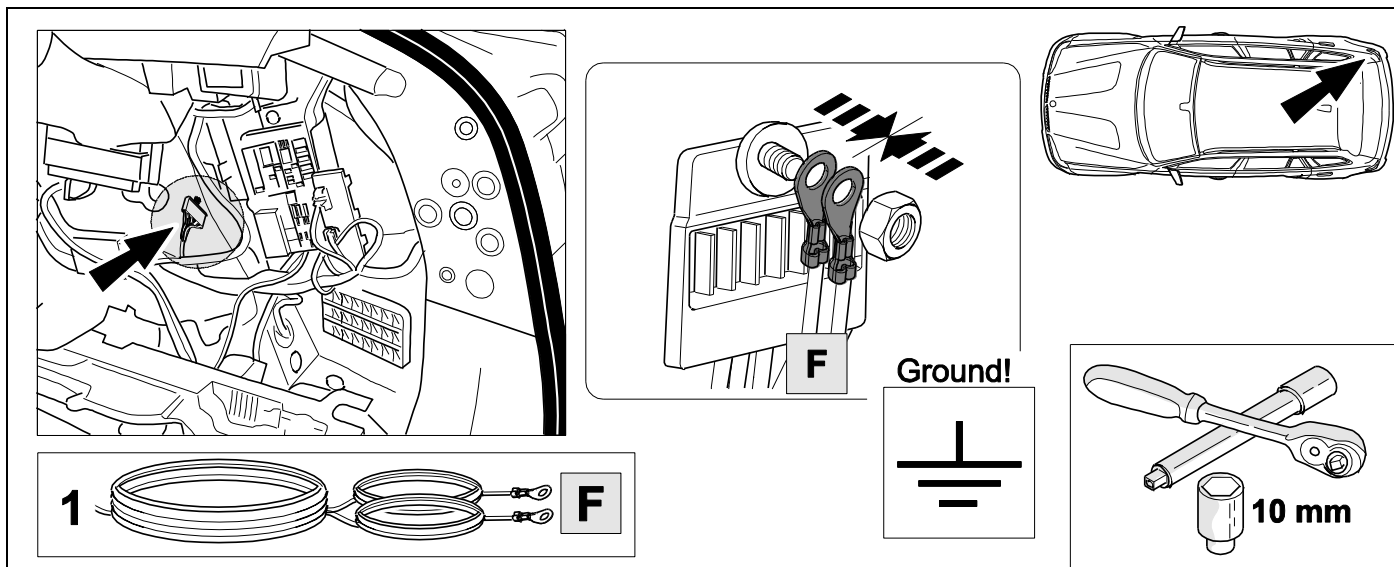

16



21

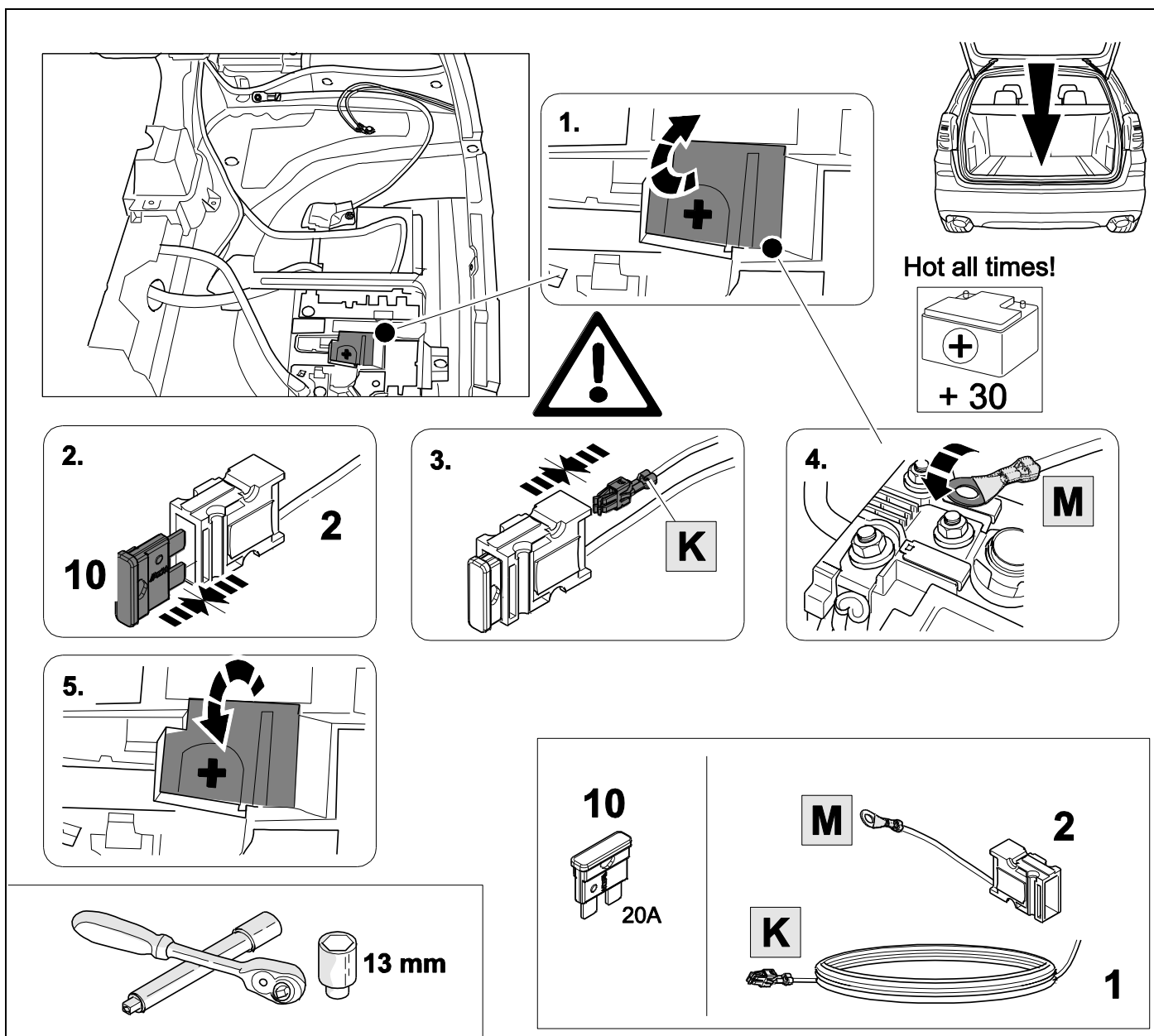

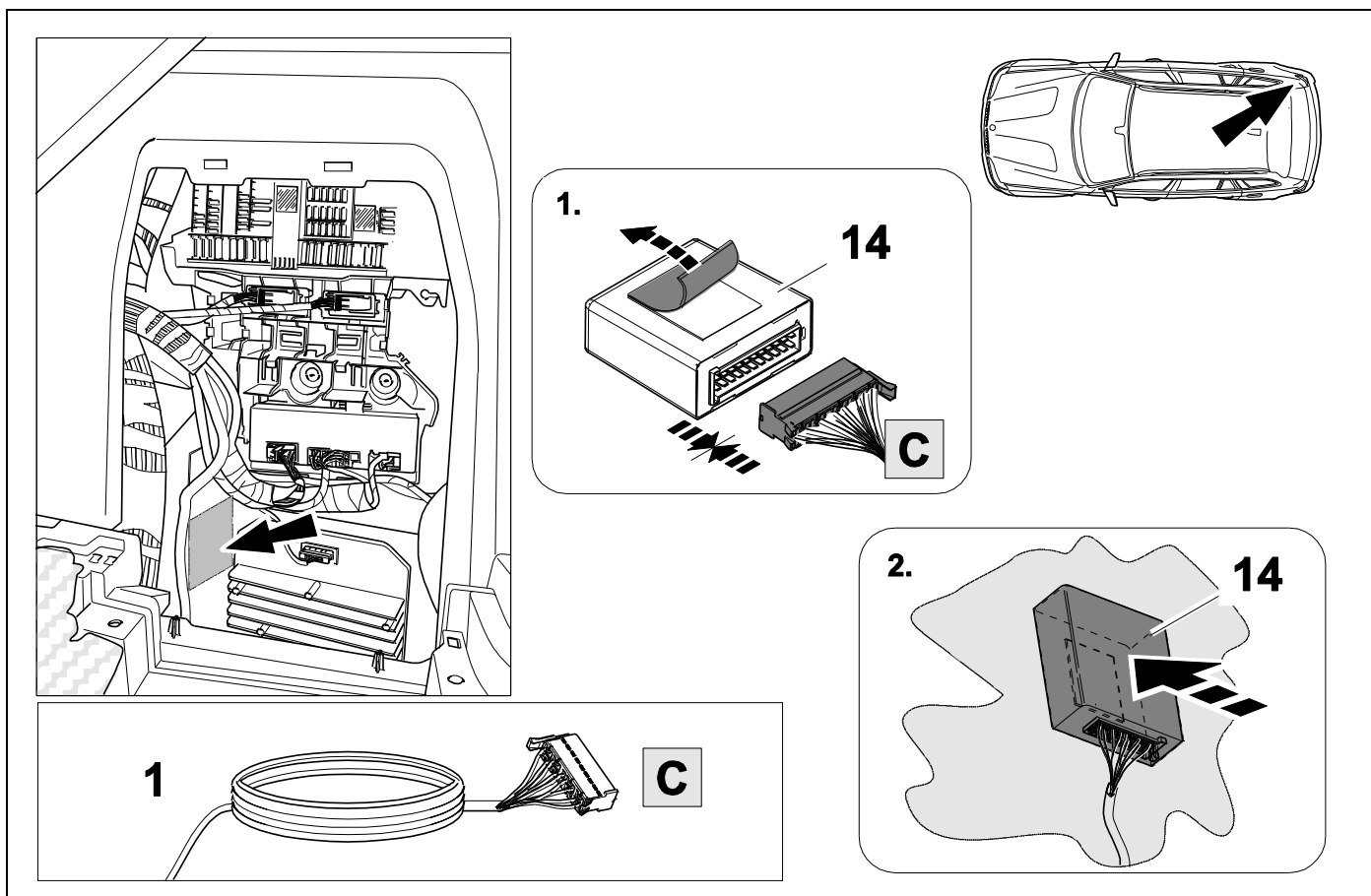



BRAKE CONTROLLER PREPARED

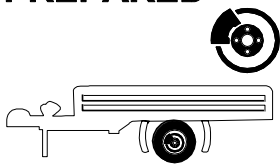

Trailer Brake Preparation

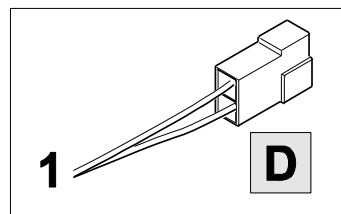

1.

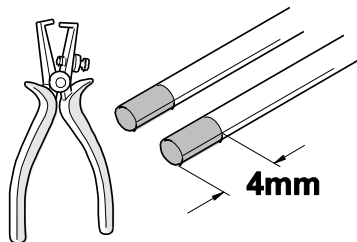

2.

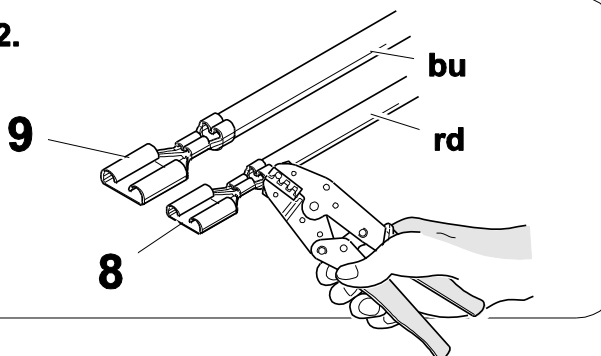

3.

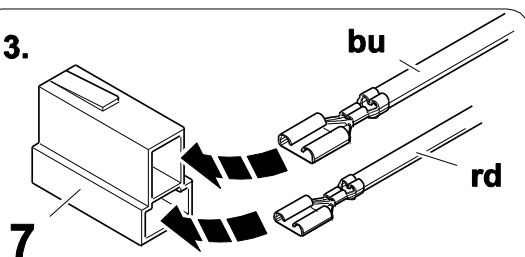

4.

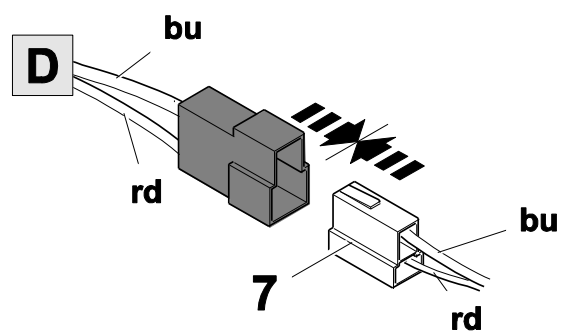

7

8

9

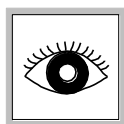
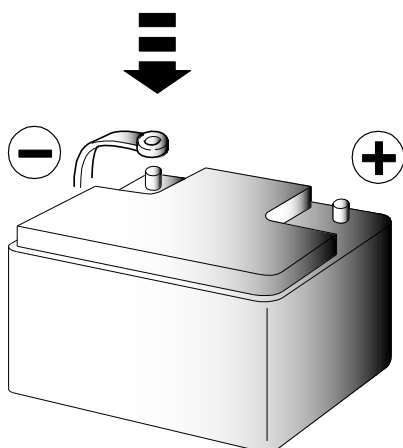
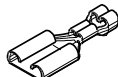
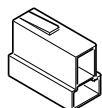

20

CHECK ALL LIGHTING FUNCTIONS

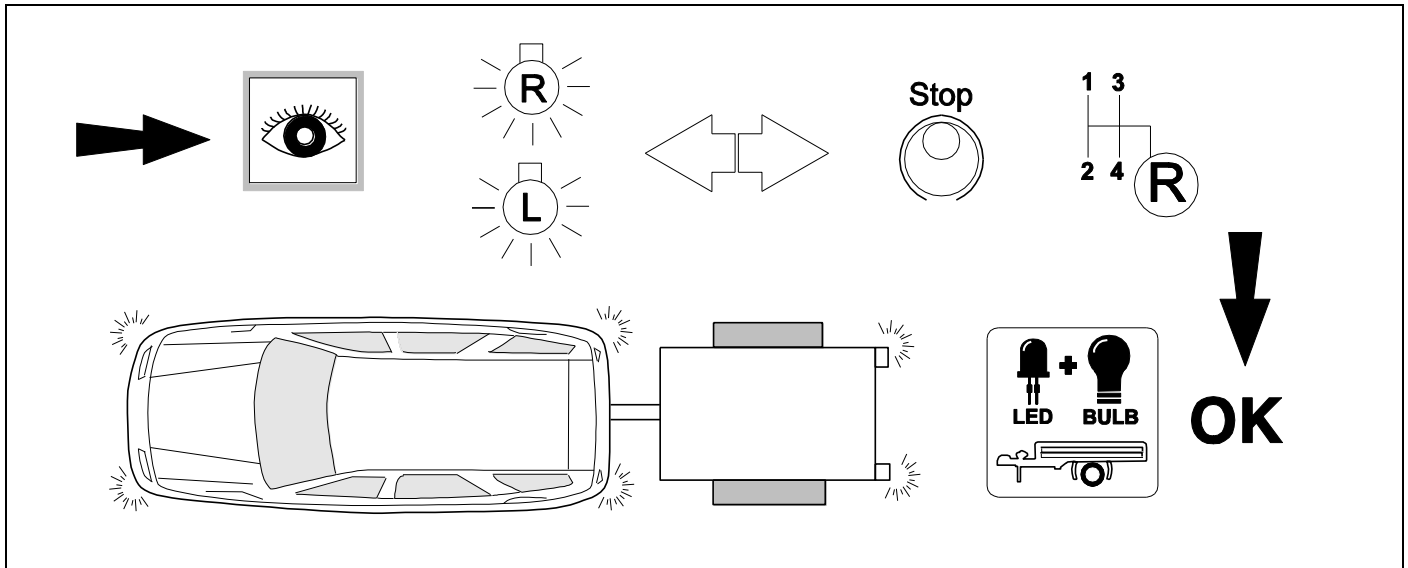

21

⇒ 16

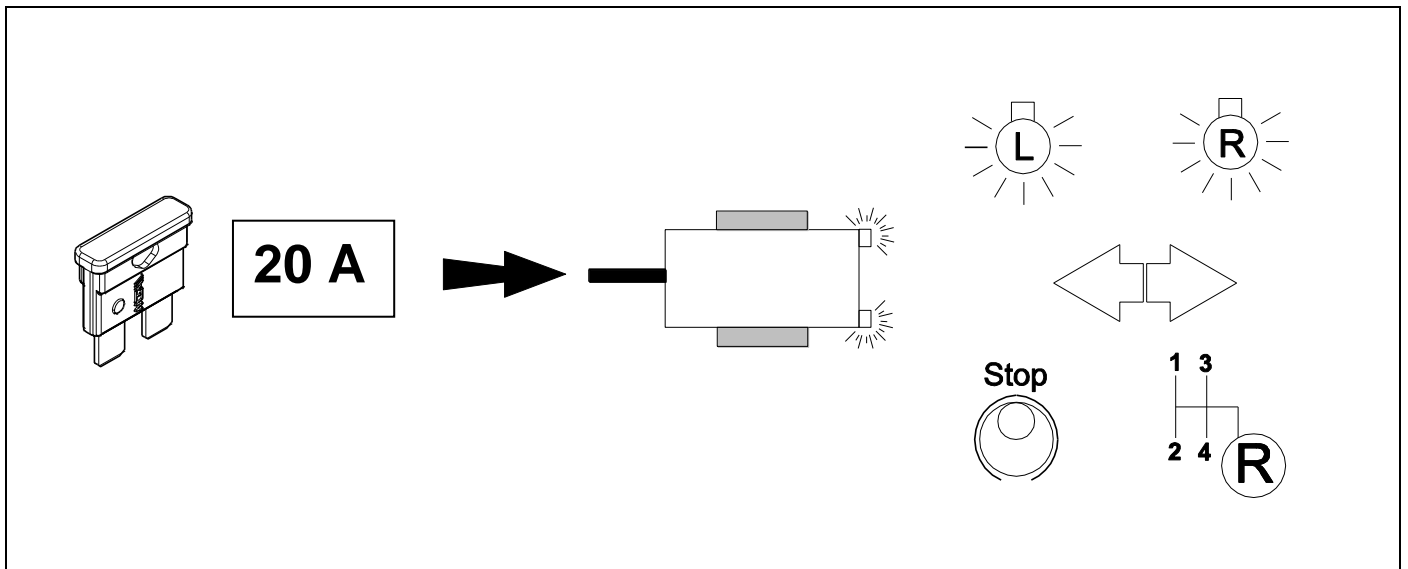

22

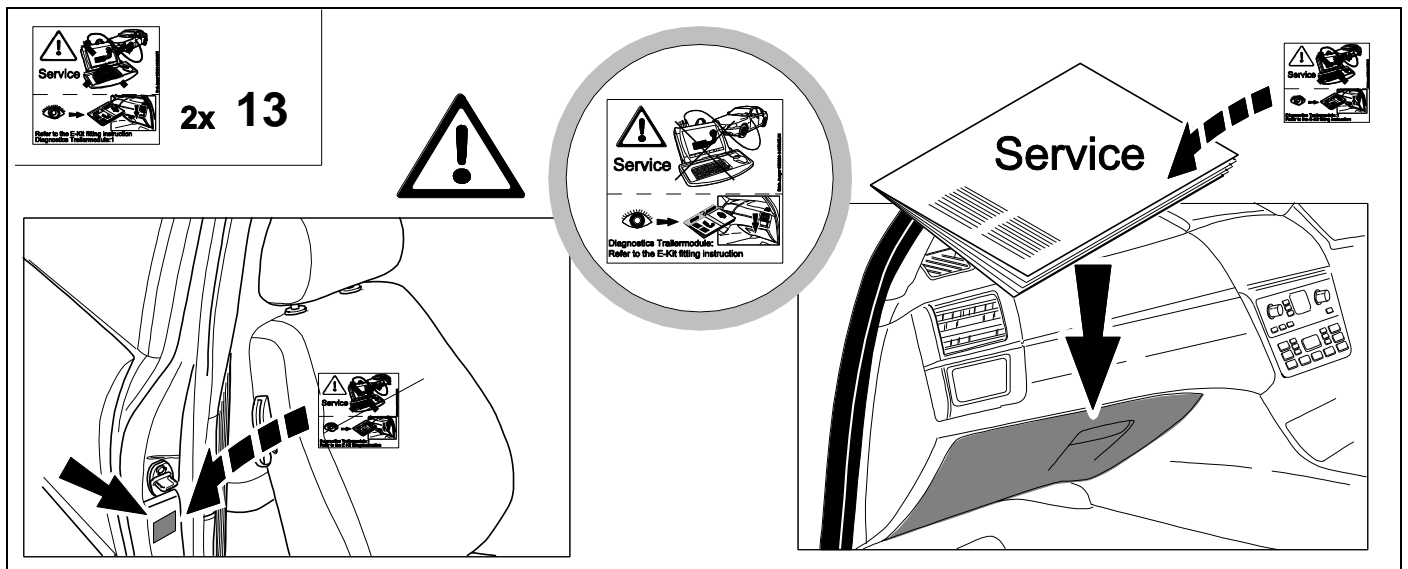

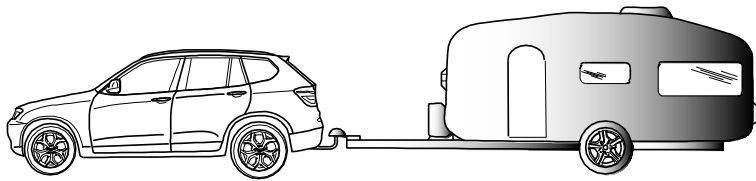

E-kit does not support assistance systems like:

- Trailer stability control
- Park Pilot
- Advanced stability control systems

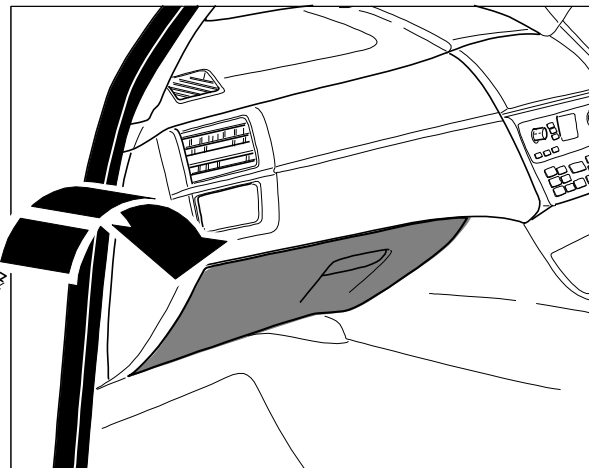
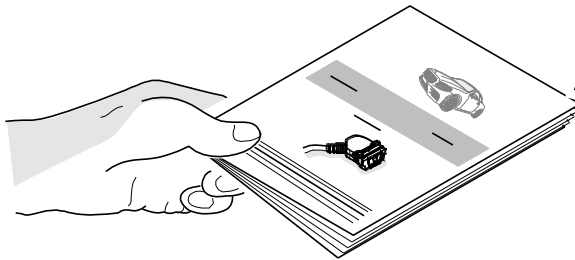

Subject to change in terms of construction, equipment and colour, and may contain errors.

The information and illustrations are non-binding.

Status LED for self-diagnosis

Operation Support

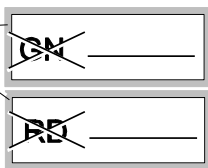
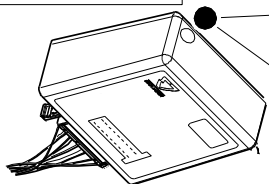
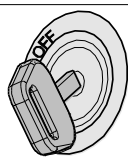

No CAN-Data

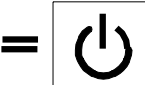

Standby / Sleepmode



Ignition OFF

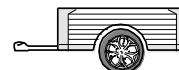
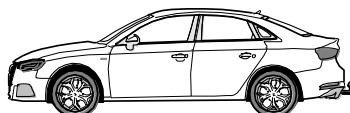
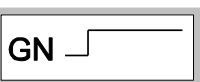
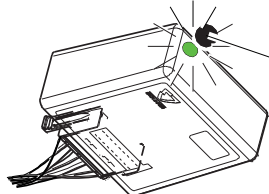

Ignition ON

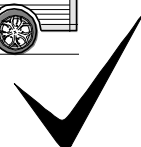
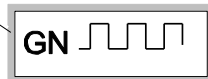
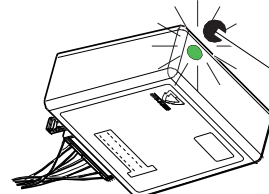

Ignition ON

Failure Support

CAN-Data Wire



1x max. 5 min.

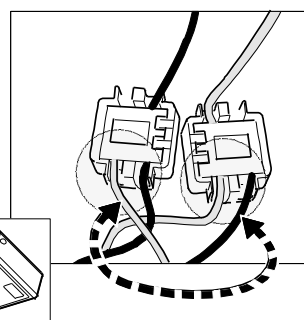
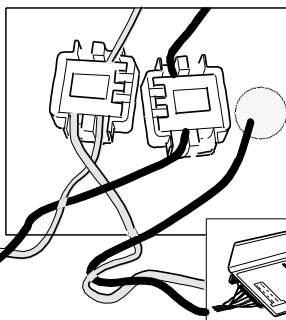
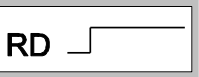
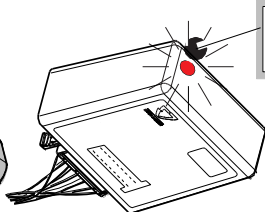

Ignition ON

Failure indicated by the module LED glowing red for a maximum of 5 minutes. If trailer connected the tail lights will also glow indicating failure of CAN signal.

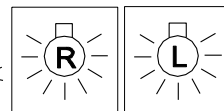

Ignition ON

