

# Fitting Instructions



SKU

**T7PA27**

PRODUCT

## **TAG Heavy Duty Towbar for VW Tiguan (05/2016 - On), Skoda Kodiaq (10/2016 - 01/2022)**

SPECIFICATIONS

- Towbar Class: CL 4 Heavy Duty
- Towing Capacity: 2500kg
- Tow ball Weight: 250kg
- Approx. Fitment Time: 60 Minutes



Scan for latest  
version of these  
instructions

TOOLS REQUIRED

- Spanners
- Sockets
- Air Saw or similar.
- Trim Removal Tool
- Torque Wrench

IN THIS GUIDE

- Fitment Instructions
- Torque Settings
- Warranty Info

# Towbar Assembly

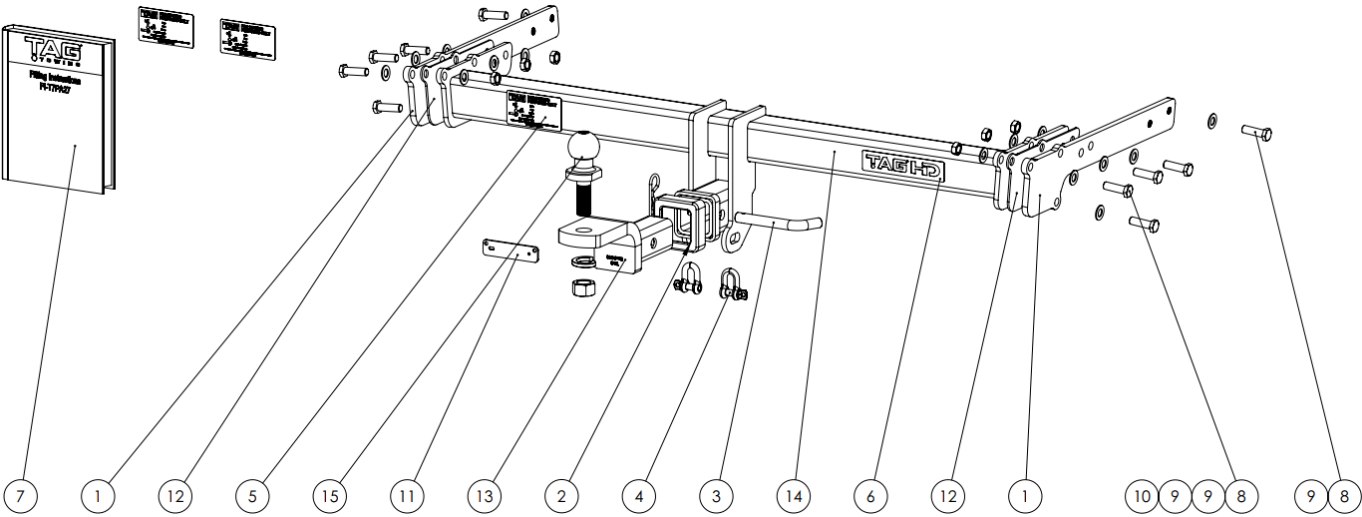

Item No.	Description	QTY.
1	VW Tiguan End Plate	2
2	TAG Hitch Cover	1
3	Class 4 Pin & Clip	1
4	D-Shackle - 10mm. 1000kg, Carbon Steel	2
5	Compliance Lable	3
6	TAG HD Sticker 150 x 33mm	1
7	Fitting Instruction	1
8	M12 x 1.25 x 40 Hex Bolt	10

Item No.	Description	QTY.
9	M12 Flat Washer Zinc Clear	18
10	M12x1.25 Nut	8
11	Backing Plate - 7 Pin Flat Connector	1
12	VW Tiguan End Cap Spacer	2
13	TAG Tow Ball Mount - L4120	1
14	Weld Assembly for T7PA27	1
15	50mm TAG Tow Ball - Chrome	1

# Important Information



**ENSURE THAT THE FITTING INSTRUCTIONS ARE READ AND UNDERSTOOD PRIOR TO FITMENT  
PLACE THESE INSTRUCTIONS IN THE VEHICLE'S GLOVEBOX AFTER INSTALLATION IS COMPLETED**

## Warning:

- This product is for towing purposes only and must only be loaded as shown in your vehicle Owner's Manual.
- This towbar is NOT to be drilled, cut, welded, or modified in any way.
- All load ratings shown are under the assumption your trailer has a functional braking system.
- When installed in positions other than the one shown in these instructions the Tow Ball/ Tow Ball Mount may interfere or obstruct certain features of your vehicle (tailgate opening, Chassis clearance, Sensor Operation, etc.)

## General:

- Before fitting this towbar check installation hardware is included and correct.
- Check that the towbar is suitable for the vehicle make, model and year then make sure any changes to the vehicle design do not conflict with the fitting of this towbar. (Tray, Canopy, Suspension etc.)
- Check behind chassis rail and body panels before drilling to ensure no hazards are present (fuel lines, electrical wires etc.)
- After drilling, blow any filings clear, remove any swarf in and around the area and treat exposed metal with a suitable rust inhibitor.
- If this vehicle requires a bumper cut out, please check to make sure that your measurements are correct and clear before cutting any panels as some bumper profiles can change. If you are not sure, then please ask your towbar supplier
- To ensure the towbar is safe and secure it is the owners' responsibility that each fastener is torqued **every 1000km**. For any reason that the fasteners are not suitable for re-torquing it is the owners' responsibility to replace all fasteners on the towbar ensuring each fastener is of the same grade (8.8) and class as the originals. Failure to do so will diminish the towing capacity of the towbar and may result in the deterioration of the chassis of the vehicle. Contact an authorised TAG distributor or the TAG fitment centre if further information is required.

## Towbar Maintenance and Care:

It is recommended, when not in use, the Tow Ball Mount assembly and class 4 Pin and Clip is stored inside the car away from moisture to prevent standing water from forming rust. Inspect to ensure, on regular basis, fasteners are torqued to the specifications below and in good condition.

Metric Bolt Torque Settings										
Diameter	Pitch	Grade	Torque	Unit		Diameter	Pitch	Grade	Torque	Unit
M8	1.25	8.8	29	Nm		M12	1.25	10.9	125	Nm
M10	1.25	8.8	57	Nm		M12	1.50	10.9	105	Nm
M10	1.50	8.8	44	Nm		M14	1.25	10.9	195	Nm
M12	1.25	8.8	101	Nm		M14	1.50	10.9	165	Nm
M12	1.50	8.8	97	Nm		M16	1.25	10.9	295	Nm
M12	1.75	8.8	77	Nm		M16	1.50	10.9	250	Nm
M14	2.00	8.8	122	Nm		50mm Tow Ball	N/A	N/A	300	Nm
M16	2.00	8.8	190	Nm		70mm Tow Ball	N/A	N/A	750	Nm



---

## Step 1: Remove Rear Bumper

---

**NOTE:** This bar is able to fit on multiple vehicle models. The procedure of removing the bumper & tail lights may be slightly different from model to model. These instructions are based on the installation of the T7PA27 bar onto a VW Tiguan (2016) however the procedure for each model will be similar. It is recommended to have the bar installed by a proficient auto parts fitter.

1. Lift the tailgate.
2. Remove the air vent panel or similar from the rear luggage compartment drivers side panel.
3. Locate and loosen the toggle screw which secures the tail light onto the vehicle.
4. Carefully pull out the tail light assembly and disconnect the harness. Set the tail light aside.

**NOTE:** Some vehicles may require to disconnect the harness connector before pulling out the tail light assembly.

5. Repeat steps 2 to 5 for the passenger side tail light assembly.

# Installation Instructions

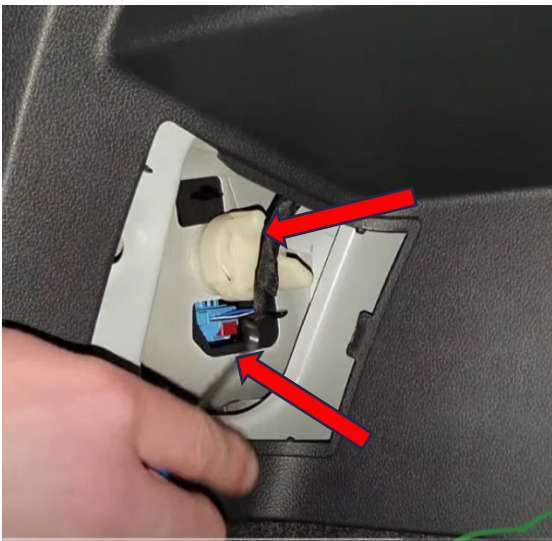
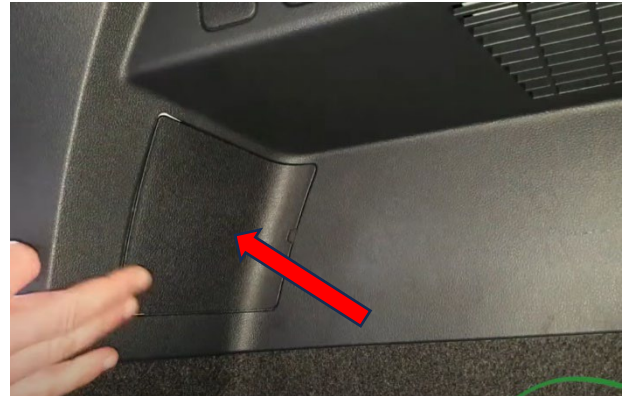

6. Remove fasteners/screws securing the wheel arch lining to the bumper. These may be Phillips head, torx, hex head or screws.



# Installation Instructions



7. Underneath the vehicle, remove any scrivets/fasteners securing the bumper to the wheel arch and the vehicles itself.



8. Carefully dislodge the plastic wheel arch trim cover by pulling firmly the bottom then peeling off the trim. Do not completely remove the trim.

# Installation Instructions



9. Remove fasteners securing the bumper to the vehicle.

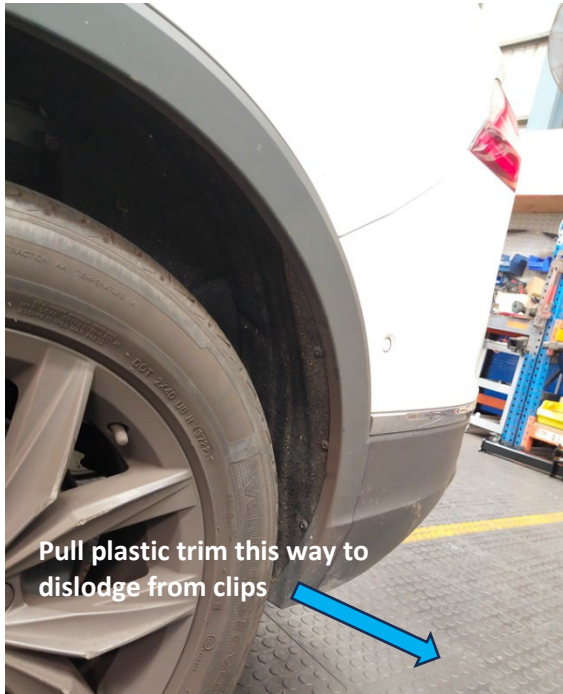

10. Dislodge the bumper from its securing clips by firmly but carefully pulling the ends.

11. Ensure to disconnect the bumper harness connector before completely pulling away the bumper. Remove and set aside.

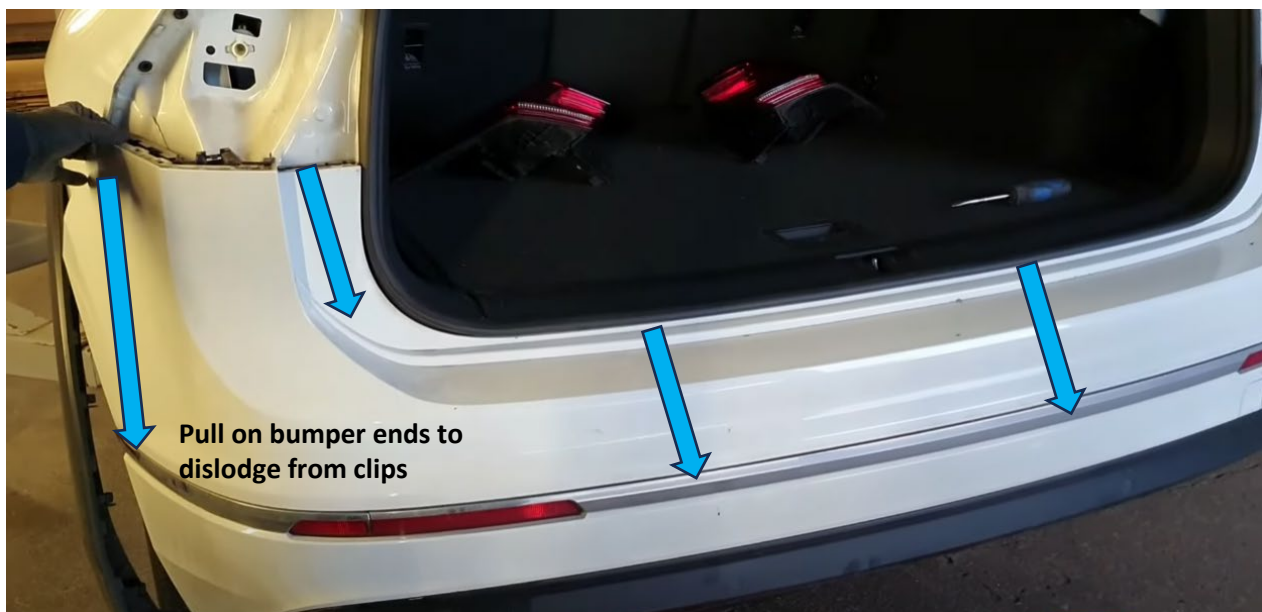

12. Remove the 6x to 8x (Vehicle Dependant) fasteners securing the crash beam onto the vehicle.



# Installation Instructions



13. Remove the crash beam. This can be discarded.



---

## Step 2: Fit Towbar

---

1. Insert the end plate into the Passenger Side chassis cavity as seen in the image. Repeat on the driver's side.





# Installation Instructions



2. Insert the End Plates until 2 of the holes line up to the holes in the chassis (1 of the front threaded holes and 1 Rear hole should line up. Use the diagram below as an example.

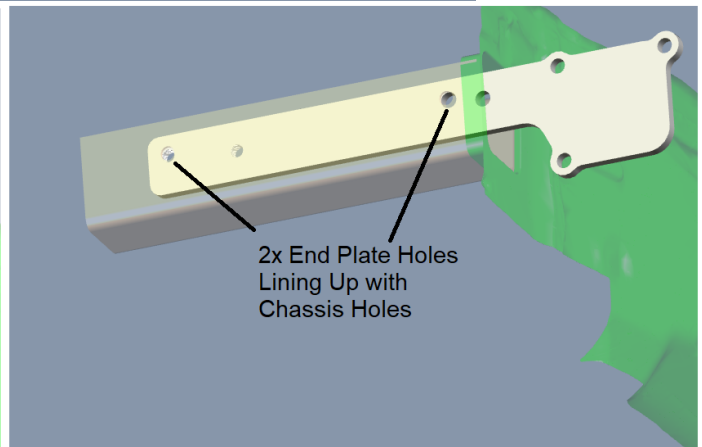
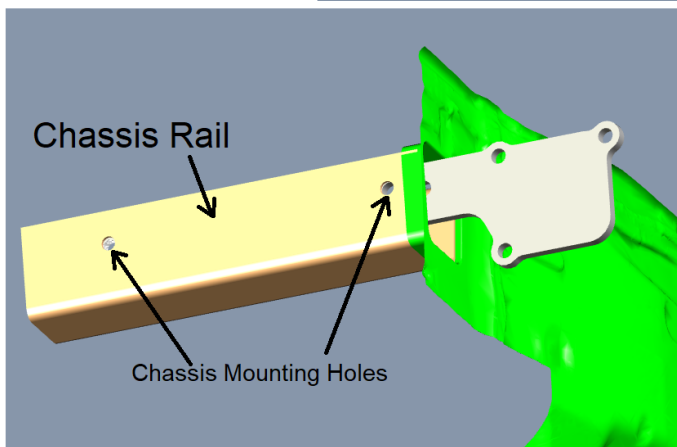
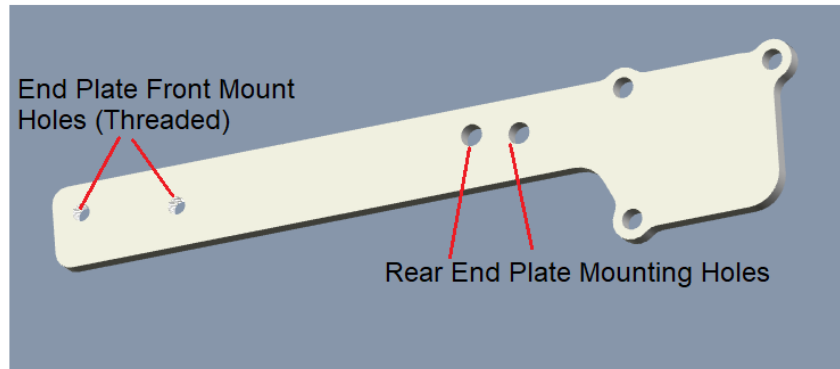

3. On the front most hole (threaded), *loosely* screw in an M12x40x1.25 Bolt (& M12 Washer) to secure the end plate in position.
4. Repeat on the drivers side.
5. Lift up the towbar centre section in between the 2 end plates and insert 6x M12x40 bolts (3 on each side) + 12x M12 Washers and 6x M12x1.25 Nuts to fit the towbar to the end plates.

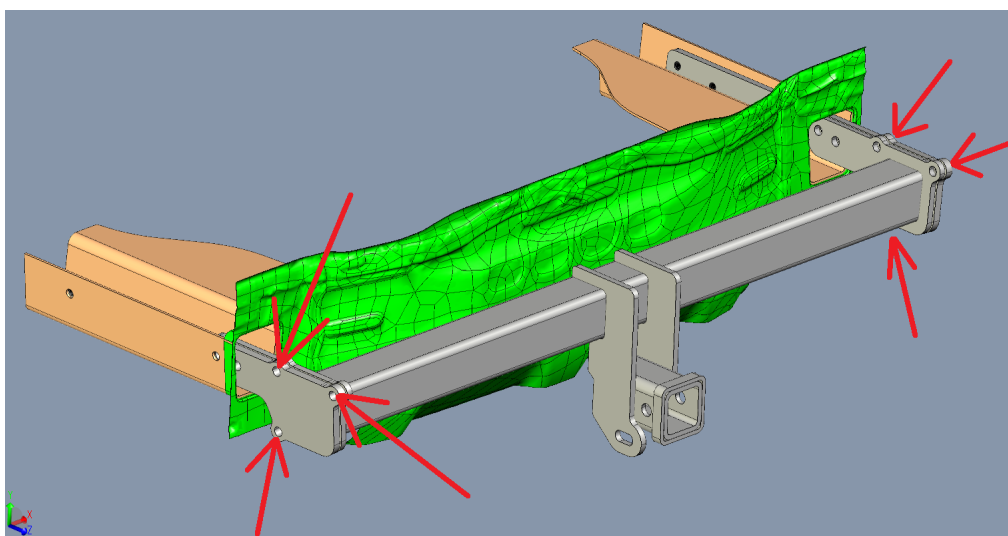

6. On the passengers side, insert an M12x40x1.25 Bolt (& M12 Washer) through the rear most chassis hole through the end plate and towbar end cap.
7. Insert an M12x1.25 Nut and M12 Washer on the inside of the chassis rail to the previously inserted bolt.
8. Repeat on the drivers side.

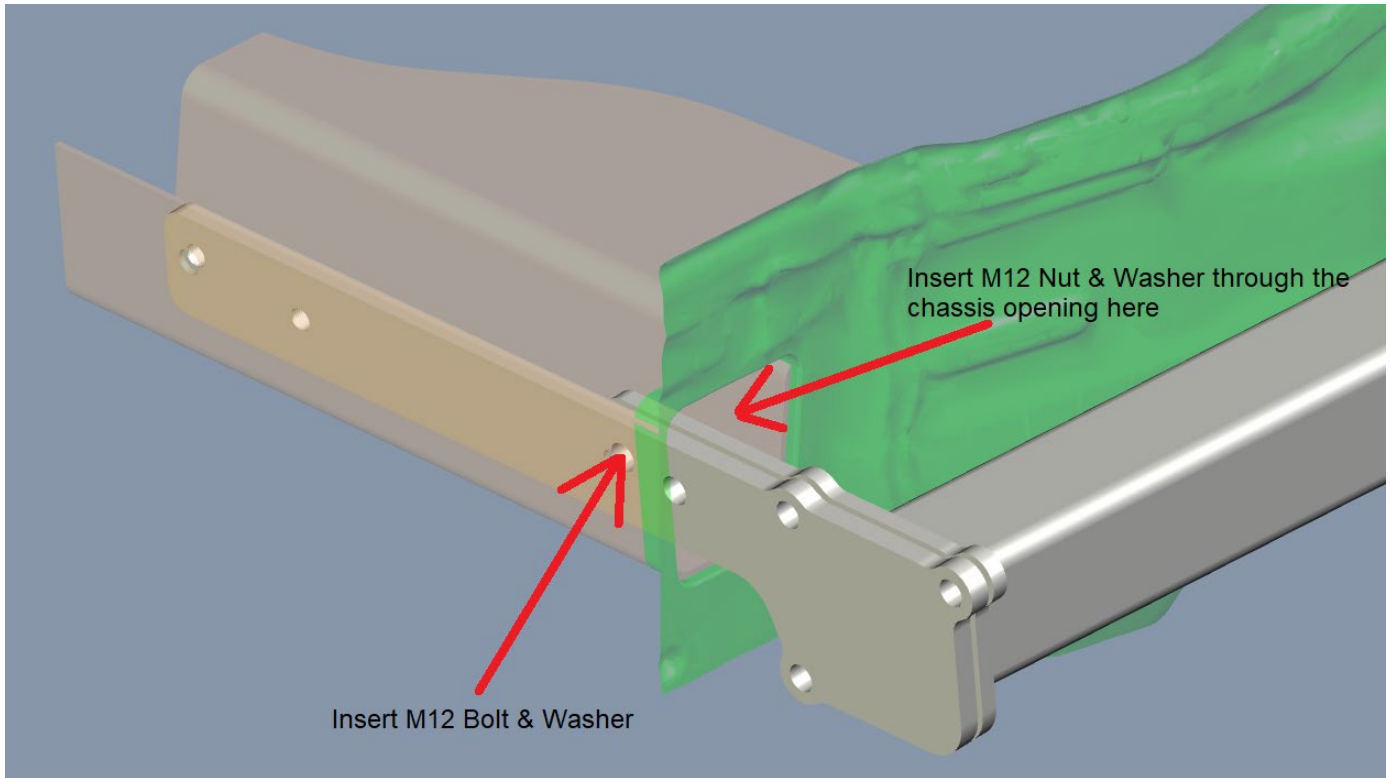

9. Starting from the chassis mounting bolts, tighten all fasteners to the torque settings specified on page 3 of these fitting instructions.
10. Re-fit all parts which were removed (except for crash bar).

# Installation Instructions



---

## Step 3: Complete Towbar & Apply Spare Compliance Label

---

- a. Attach TAG Hitch cover with rubber mallet carefully to prevent breaking.
- a. Attach the tow ball to the ball mount. The flat side of the tow ball **MUST BE** parallel to the outer edge of the ball mount. **Tighten the tow ball to 300Nm.**
- b. Insert the ball mount into the receiver and secure with the Pull pin and R-Clip. When not in use, secure the Ball Mount in a safe place inside your vehicle.
- c. Apply one of the compliance labels to the pillar of the driver's door. Place the remaining label and the fitting instructions in the vehicle handbook.

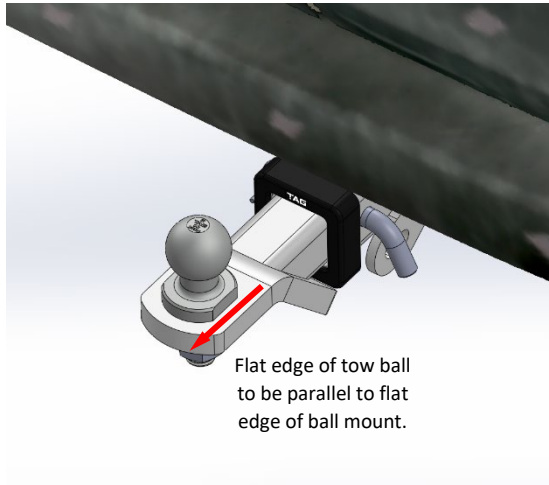

# TAG Warranty Statement



SWD warrants your TAG Towbar for its full product life under the following conditions:

- You can show proof of purchase.
- The towbar has been correctly installed by a suitably qualified installer.
- The towbar has not been modified or abused in any way and has only been used for the purpose intended.
- The towbar was not fitted second hand to your vehicle.

The extent of this warranty includes materials and workmanship used in the manufacture of the towbar and is to the equivalent value of current, full replacement cost.

Nothing stated or implied in this warranty limits in any way, the statutory rights that you may have.

To make a claim visit the original installer in the first instance or, if you are unable to or are not satisfied with their help, then contact us direct by phone on 1300 669122 or visit [www.swd.com.au](http://www.swd.com.au).